

C&H SERVICES SBU



RIF0mat-WO 1011 & 1211

Float Controlled Steam Trap

■ What is RIF0mat-WO 1011 & 1211 Steam Trap ?

A steam trap is an automatic valve which closes to trap steam & opens to discharge condensate, air & non-condensable gases from the steam system. The RIF0mat-WO float controlled steam trap is an ideal choice for removal of condensate at all process industries, sugar industry, refinery & petrochemicals. Application of this trap is for shell & tube heat exchangers, evaporators & reboilers.

Features

- Very high resistance to water hammer.
- Specially designed Rotary slide valve ensures modulating flow controls at various loading conditions.
- Highly recommended for very low differential pressure & very high condensate load condition.
- Increasing level opens and decreasing level closes the outlet port.

Capacity Chart

Performance:

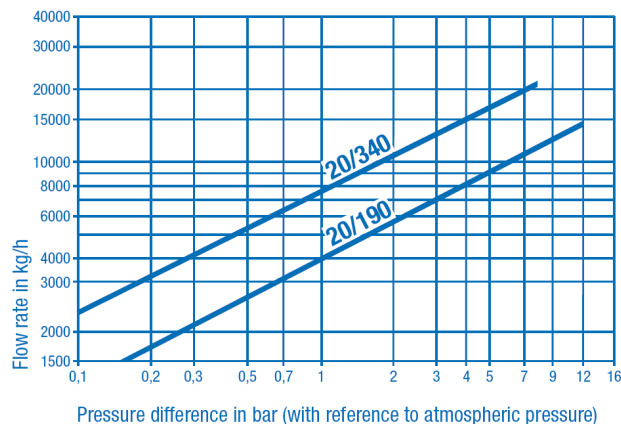

Materials

No	Component	Material	Specification
1	Body	Carbon Steel	ASTM A106 Gr. B
2	Cover Plate	Carbon Steel	ASTM A516 Gr. 70
3	Vent Plug	Carbon Steel	ASTM A105
4	Gasket (SWG)	SS	SS 304 + Graphite
5	Drain Plug	Carbon Steel	ASTM A105
6	Float	Steel	ASTM A240 Gr. 304
7	Immersion Tube	Steel	ASTM A321 Gr. 304
8	Drain Tube	Steel	ASTM A276 Gr. 304
9	Supporting Screw	Steel	ASTM A479 Tp. 304
10	Stud & Hex Nut	Steel	ASTM A193 Gr. B16 ASTM A194 Gr. 8M

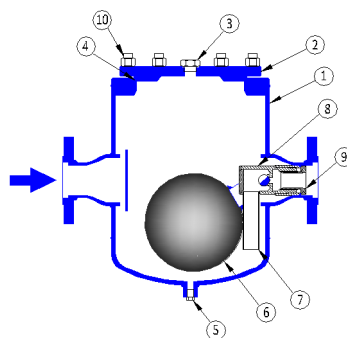

Body Design Conditions

Parameter	W0-1011	W0-1211
Maximum Operating Pressure - PMO (kg/cm ²)	16	40
Maximum Operating Temperature - TMO (°C)	425	425

End Connections :

Flanged end as per ASME B16.5 - others on request

Size : DN 50 / DN 80 / DN 100

Certifications : Indian Boiler Regulation (IBR)
On request.

Dimensions & Weight

Size	A	B	C
DN 50	430	230	210
DN 80	450	230	210
DN 100	450	230	210

Weight : Maximum weight of trap is 75 Kg.

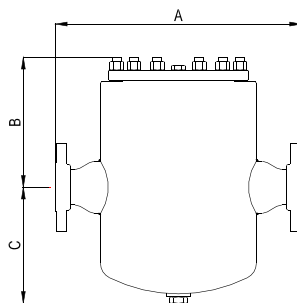

For more information, please get in touch with your nearest Thermax representative. You can also mail us at info.c&hservices@thermaxindia.com or visit us at : www.thermaxindia.com.

In view of our constant endeavor to improve the quality of our products, we reserve the right to alter or change specifications without prior notice. All photographs shown in this publication are representative in purpose, and to be used for reference only. For actual details and specifications, please refer to Thermax offer document.



THERMAX

Sustainable Solutions in
Energy & Environment

COOLING & HEATING DIVISION Services SBU

D - 13, MIDC Industrial Area, R. D. Aga Road,
Chinchwad, Pune 411 019. INDIA
Tel. : +91-20-6615 5000
1800-209-0115(India Toll Free)
Fax : +91-20-2747 7080
E-mail : info.c&hservices@thermaxindia.com

AHMEDABAD 380 006

Tel. : (079) 2657 5408 / 5341 / 7073
Fax : (079) 2657 7270
E-mail : aadmin@thermaxindia.com

BANGALORE 560 001

Tel. : (080) 2237 1721- 25
Fax : (080) 2237 1726
E-mail : receptionblr@thermaxindia.com

CHENNAI 600 018

Tel. : (044) 2430 3400
Fax : (044) 2435 3841
E-mail : chennaiereception@thermaxindia.com

HYDERABAD 500 081

Tel. : (040) 2325 3700
Fax : (040) 2325 3799
E-mail : hyd_secretary@thermaxindia.com

MUMBAI 400 039

Tel. : (022) 6754 2222, 2285 2058
Fax : (022) 2204 0859
E-mail : madmin@thermaxindia.com

NEW DELHI 110 034

Tel. : (011) 4608 7200
Fax : (011) 2735 5211
E-mail : admindel@thermaxindia.com

KOLKATA 700 019

Tel. : (033) 6607 0800 / 900
Fax : (033) 6607 0999
E-mail : dipudas@thermaxindia.com

International Offices:

MIDDLE EAST (DUBAI)

Tel: +9714-8861424;
E-mail: info@thermaxdubai.ae

SOUTH EAST ASIA (MALAYSIA)

Tel: +60127798493
Email: thermax@tm.net.my

HO, AFRICA, SAARC & OTHER COUNTRIES

Tel: +91-20-6615 5000
Email: info.c&hservices@thermaxindia.com

International offices:

Indonesia, Russia, Kazakstan, Saudi Arabia,
Bangladesh, Sri Lanka, Hong Kong, China,
Thailand, Malaysia, Philippines, UAE, Kenya,
Nigeria, Brazil, UK, USA

Thermax Business Portfolio

Boilers & Heaters

Absorption Cooling

Air Pollution Control

Captive Power

Chemicals

Water & Waste Solutions